

# ADAPTAWear

clothing for care

Designed to make dressing quicker and easier for wearer and carer

## Front-Fastening Bras and Adaptive Nightwear

Fastening a bra gets more difficult as we get older and for ladies who have arthritis or limited arm movement, getting dressed can be time consuming and painful.

Choose from The Adaptawear Corebra or the Royce Comfi bra - front fastening cotton bras that are designed for gently support and comfort.

If you require flat back opening nightwear see our pretty adaptive nightwear on page 3.

### Magnetic Corebra - How to get the perfect fit

Follow our easy guide below to determine the fit you will need. The best way to find out the right bra size is to determine your size by the traditional route of measuring.

#### Find your bra size

This is under the bust measurement. Measure, in inches, directly under your breasts, ensuring that the tape is firm and level across your back. If this number is even, add 4". If this number is uneven, add 5". This is your bra size.

#### To find your cup size

Measure around the fullest part of your bust. Again, ensure that the tape is level. This is your 'Over Bust' measurement.

With these two measurements, use the table on the right to determine which Corebra size will provide the best fit.



Finger loops for easy grasping



## Corebra - The Magnetic Front-Fastening Bra

Adaptawear's unique Corebra has been designed with extensive input from Occupational Therapists. The Corebra is a comfort bra that offers **gentle support**, it will not give the same uplift as an underwired bra.

- Magnetic and hook and loop fastenings replace tiny bra hooks
- Front fastening with large, easy-to-grasp finger loops
- No restrictive cups sizes, only soft expandable cotton that moulds to your body shape
- Racer back fit reduce shoulder strain
- Wide adjustable straps
- 93% Cotton 7% elastane
- Not suitable for people with pacemakers
- Available in black and white

VAT Relief

Encourages ladies to dress themselves

Code **CORE** £28.00 (ex. vat £23.33)

Over bust measurement		32-34"	36-38"	40-42"	44-46"	48-50"
	1-3" (2.4-7.6cm) more than Bra Size (A-D cup)	Size 1	Size 1	Size 1	Size 1	Size 1
4-6" (10.1-15.2cm) more than Bra Size (E-G cup)	Size 2	Size 2	Size 2	Size 2	Size 2	

See the Comfi Bra on p2



Full range online

Orderline: 0845 643 9492

[www.adaptawear.com](http://www.adaptawear.com)



Easy-fasten poppers

As low as **£24.00** Each

### Comfi Bra

Front, easy-fasten, poppers for all round comfort.

- One bust size fits A-D cup, use your under bust measurement to get correct size
- 98% cotton 2% elastane

Sizes: 34/36/38/40/42

Code **BR2 Comfi Bra** £24.00

Chest Measurement	Bra Size
29 - 30" (73 - 77cm)	34
31 - 32" (78 - 82cm)	36
33 - 34" (83 - 87cm)	38
35 - 36" (88 - 92cm)	40
37 - 38" (93 - 97cm)	42

Tape measure should be snug, but not tight. Measure around ribs, just below bust.

Only **£15.50** Each



### Fleecy Wrap

These brightly coloured, lightweight fleecy wraps are great for keeping the chills off your shoulders and arms when reading in bed, watching TV, or sitting at the computer. Made in the UK from top quality anti-pil fleece. Easy-care and quick drying.

Colour: Cerise Pink. Size: One size.

Code **CT/FW** £15.50



Hook & loop fastening, ideal for stiff fingers

Ideal gift

Cerise Pink



### Fleecy Cape

This double layer fleecy cape with collar will keep the chills away. Extremely easy to wear as an alternative style of bed-jacket, or when sitting for long periods in a chair. Its velcro style fastening makes it easy to put on and take off for stiff fingers. Ideal for ladies recovering from surgery, have limited dexterity or mobility problems.

- Made in the UK from top quality anti-pil fleece, it is machine washable and quick drying.
- Please note: The sizing is generous. We recommend this **Size guide**: XSmall (8-12) Small (12-14), Medium (16-18), Large (20-22).

Colours: Cerise Pink, Turquoise.

Code **CT/EC** £25.50

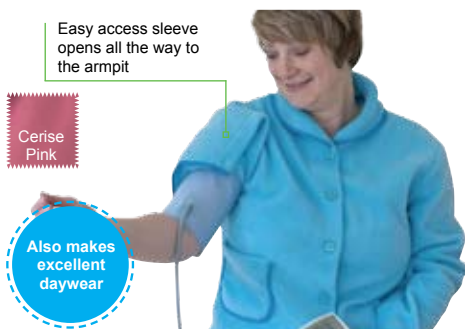

Easy access sleeve opens all the way to the armpit

Cerise Pink

Also makes excellent daywear

### Easy Access Fleecy Bed-Jacket

Nothing beats a warm cosy bed jacket. Ideal for home use or a stay in hospital, our fleecy jacket is designed for superb comfort and ease of use. Easy access sleeves have poppers opening to the armpit, with no need to remove the jacket for blood pressure or other medical procedures. It is also great for wearers of plaster casts. There is a handy pocket and buttons-up to keep the chest and neck warm.

Colours: Cerise Pink, Aqua

Sizes: XSmall, Small, Medium, Large, XL

Code **BJ1** £22.50



Soft lingerie fasteners, kind to delicate and sensitive skin

Pretty nightdress with a unique design

## Adaptive Gown

This pretty nightdress has a unique design making it ideal for ladies who have suffered a stroke, multiple sclerosis, rheumatoid arthritis, motor neurone disease or cancer.

It also reduces the level of distress for dementia sufferers who become agitated when being dressed or dislike clothes going over their head. Palliative nurses can gently roll a patient into the nightie which minimises discomfort and maintains dignity.

- Back opening with split sleeves and can be opened flat
- Seersucker, 50% cotton, 50% polyester

**Colours:** Pink, Blue

**Sizes:** 1 (12-14), 2 (16-18), 3 (20-22), 4 (22-24)

Code ANNE £34.00 (ex. vat £28.33)



Generous overlap maintains dignity

Only  
**£12.92**  
Each

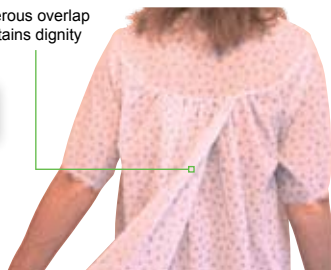

## Open Back Nightie

Elegant, with pretty lace detailing, and a favourite with wearers and carers alike. Overlaps at the back maintaining dignity at all times, ideal for continence problems.

- 65% polyester 35% cotton
- ¾ length and short sleeved

**Colours:** Various floral prints

**Sizes:** 12-14, 16-18, 20-22, 24-26, 28-30

Code N47 £15.50 (ex. vat £12.92)



## Front-Opening Nightie

A jersey polycotton button-up nightie with pretty floral print. The front-opening design and large buttons make it easier to put on.

- 2 handy pockets

**Colours:** Cream, Pink

**Sizes:** S/M, M/L, L/XL, XL/XXL

Code FON £15.50

The fabric pattern in our nightwear range may differ slightly from the photos.



Full range available online

[www.adaptawear.com](http://www.adaptawear.com)



**Orderline: 0845 643 9492** (lines open 9am - 5pm Mon-Fri)

**Cotton Long Leg Pants**

100% white cotton interlock pants with chill-beating longer cuff leg.

Sizes: 12-14, 16-18, 20-22, 24-26

Code PC/IP £5.00 each



A range of traditional cotton underwear that is difficult or even impossible to find on the high street. Whether you prefer the longer leg interlock cotton pants or the eyelet briefs, we offer a broad selection of sizes that will suit all body shapes.

**Cotton Eyelet Pants**

Eyelet pattern with a longer leg length. 100% white cotton.

Sizes: 12-14, 16-18, 20-22, 24-26

Code PC/EP £4.50 each

**Cami Vest by Brettles**

Established in 1786, Brettles quality underwear is still a firm favourite with ladies of all ages. This pretty Cami Vest is soft and gentle next to the skin. 100% knitted combed cotton.

Sizes: Medium, Large, XL

Code BCAMI £6.50

**Interlock Briefs**

Perfect for wearing with trousers, 100% interlock cotton provides all day comfort.

Sizes: 12-14, 16-18, 20-22, 24-26, 28-30

Code CIB £4.00 each

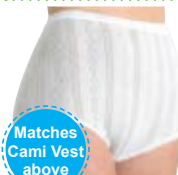

Matches Cami Vest above

**Briefs by Brettles**

Matching Brettles Briefs

Sizes: 12-14 (M), 16-18 (L), 20-22 (XL)

Code CBB £5.00 each

**Polycotton Full Briefs**

In hip sizes 38/40" up to 60/62" this 3 pair pack of ladies full size briefs offers great value and all-day comfort. Made from 65% polyester & 35% cotton.

Colour: Mixed pastel shades

Sizes: 38/40, 42/44, 46/48, 50/52, 52/54, 56/58, 60/62

Code PFB 3 pack £8.50



Fits up to size 62" hip

**VAT Exempt Information**

Only products that are specifically adapted to aid disability or for the chronically sick are eligible for VAT relief. These products are shown with prices including and excluding VAT e.g. Open-back trousers.

These products are only available at zero-rate VAT when purchased directly by an individual for their 'domestic or personal use'. In order for us to meet "yours and our" obligations to Customs & Excise, and in order to avoid paying VAT on certain items, you will be required to sign a simple declaration form at the checkout that confirms that you are eligible to receive goods which are zero-rated.

Please note we are only able to exempt VAT from the actual goods, all delivery charges will attract VAT as normal.

**Out of Stock Items**

Due to ever changing stock levels, there may be times when your chosen items are out stock. If this happens, we will contact you within two days of receiving your order and advise you of the expected delivery date. A guide to stock levels can be found on the web site and we try to keep this as up to date as possible.

**Returns Policy and Refunds**

We aim to provide quality products and a first class service to our customers however there are occasions when you may wish a refund or an exchange, please complete the returns / exchange form which will be in the parcel.

Please note that under no circumstances will we accept the return of a garment which shows signs of having been worn or tried on for an extended period. We reserve the right to refuse to accept the return of a garment which has been badly repacked and cannot be put back into stock. It will be returned to the customer.

Adaptawear, 127 Salisbury Road, Worcester Park, Surrey KT4 7BU.

Adaptawear and Cloutietree are trading names of Crawford MacEwen Ltd. Prices in this catalogue include VAT at the rate of 20%.

The company reserves the right to change the prices of a product without prior notification.

VAT Relief

Payment Options - Card, cheque or Paypal

