

# oxford

Together we  
transform lives

## User Instruction Manual

### Oxford® Stretcher Adjustment Cradle

To avoid injury, read user manual prior to use. For alternative languages, contact your authorised service provider. Always refer to [www.oxfordhealthcare.co.uk](http://www.oxfordhealthcare.co.uk) for latest revision.

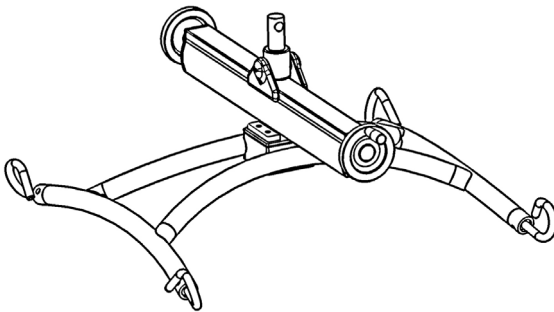

## Contents

1. Oxford Stretcher Adjustment Cradle .....	3
2. Safety Precautions .....	4
3. Assembly & Commissioning Instructions .....	6
4. Lifting With Your Oxford Stretcher Adjustment Cradle.....	12
5. Maintenance .....	14
6. Warranty .....	15

## Symbols



This product is a Medical Device in accordance with EU Medical Device Regulation 2017/745.



Certification mark indicating conformity with the applicable requirements for products sold within Great Britain.



Area/side for feet/legs



A point of contact between the non-European medical device manufacturer, the national Competent Authorities (Ministry of Health) and Notified Bodies.



Area/side for head



ATTENTION, consult accompanying documents.



A unique device identification intended to provide single, globally harmonised positive identification of medical devices through distribution and use.



Refer to the user instructions before use (Blue background).



Indicates the entity importing the medical device into the locale.

# 1. Oxford Stretcher Adjustment Cradle

As an aftermarket accessory, you can retro-fit your Oxford Stature/Presence lift with an Oxford Stretcher Adjustment Cradle (See Fig.1). This is installed in place of the 6-point Spreader Bar or 4-point Cradle.

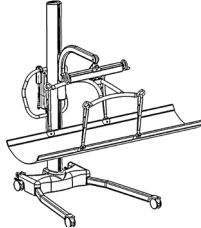

Fig. 1

**Safe Working Load** when fitted with the Oxford Canvas Stretcher (Item Number SL30010) is **227Kg (500lbs)**.

## Intended Use:

OXFORD RECOMMENDS THE USE OF GENUINE OXFORD PARTS. The Oxford Presence and Canvas Stretcher are designed to be compatible with one another. For country specific guidance on their use and compatibility, please refer to the product label(s) or contact your local market distributor or Oxford.

Oxford cannot state that all hoists and stretcher products are compatible. However, should a competent person carry out an appropriate risk assessment prior to prescription, and is confident that the hoist and stretcher can be used together safely, then that decision and responsibility is quite rightly with the prescriber. If in doubt, seek advice.

The Stretcher Adjustment Cradle is intended for levelling a patient on the chosen stretcher prior to lifting to ensure the patient maintains a horizontal position for safety and comfort.

The Stretcher Adjustment Cradle is for use by a minimum of two trained operators.

The Stretcher Adjustment Cradle is connected simply to the chosen Oxford lift by the use of a quick release pin.

Advantages of the Oxford Stretcher Adjustment Cradle include:

- Adjustment can be made by operating either the left or right hand levelling handles
- The balance can be adjusted using one hand.

## Serious Incident Reporting:

In the event of a serious incident taking place during use of this product, affecting the patient and/or care-giver, it must be reported to the product manufacturer or authorised distributor. Should the incident take place within the European Union (EU), it must also be reported to the local competent authority within the member state.

## Operation/Storage Conditions:

Operating temperature ..... 5°C to 40°C  
 Storage temperature..... 5°C to 40°C  
 Relative humidity ..... 10% to 95%

## 2. Safety Precautions

### ⚠ WARNING

When the stretcher is attached, the patient's head and body should always remain horizontal. This balance is achieved by operating the adjustment handles in either a clockwise or anti-clockwise direction (See Fig.2).

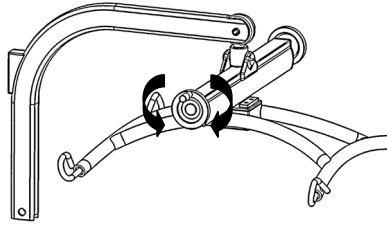

Fig. 2

### ⚠ WARNING

Ensure the patient is positioned in the correct orientation prior to connection of the stretcher to the Stretcher Adjustment Cradle (See Fig.3).

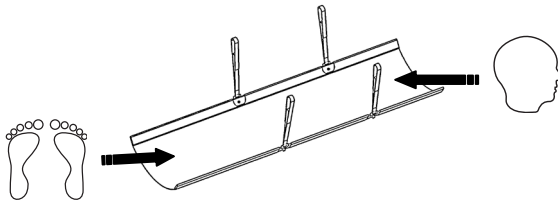

Fig. 3

### ⚠ WARNING

Do not attempt to lift the patient if the patient's weight is off centre balance (See Fig.4).

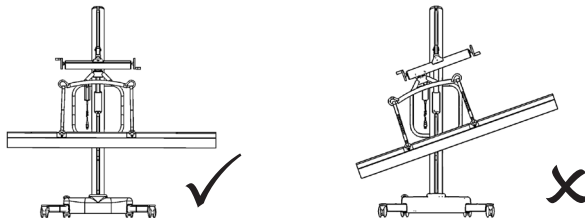

Fig. 4

**⚠ WARNING**

- The Oxford Stretcher Adjustment Cradle is **ONLY** compatible with the Oxford Stature and Presence lifts.
- **OXFORD RECOMMENDS THE USE OF GENUINE OXFORD PARTS.** The Oxford Presence and Canvas Stretcher are designed to be compatible with one another. For country specific guidance on their use and compatibility, please refer to the product label(s) or contact your local market distributor or Oxford.
- Oxford cannot state that all hoists and stretcher products are compatible. However, should a competent person carry out an appropriate risk assessment prior to prescription, and is confident that the hoist and stretcher can be used together safely, then that decision and responsibility is quite rightly with the prescriber. If in doubt, seek advice.
- Never use a stretcher if the suspension straps are cut or frayed or the stitching is damaged.
- Always plan your lifting operations before commencing the lift.
- Always check the Stretcher Adjustment Cradle is in good working order prior to all lifting operations.
- To assemble the Stretcher Adjustment Cradle to the hoist, two persons are required due to the weight of the unit (15.4 kg).

### 3. Assembly & Commissioning Instructions

The following components are included with your Stretcher Adjustment Cradle (See Fig. 5).

1 x Stretcher Adjustment Cradle (2 pieces)

4 x Bolts & Fixings (not shown)

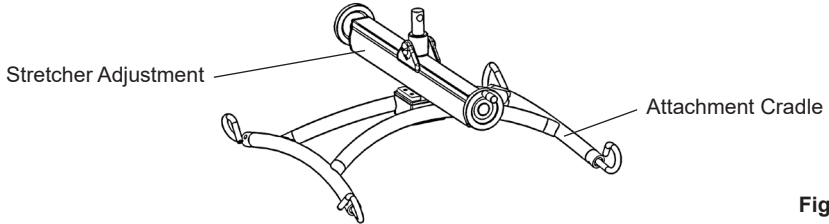

Fig. 5

#### Initial Assembly

1. Place the attachment cradle on to a flat surface (See Fig. 6).

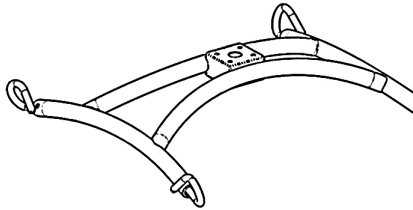

Fig. 6

2. Align the stretcher adjustment with the attachment cradle. Orientate the stretcher adjustment so that it is parallel to the adjustment cradle hooks (See Fig. 7).

**NOTE:** Holes will not line up if the cradle is incorrectly aligned.

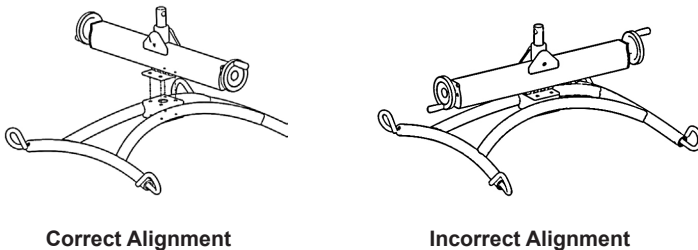
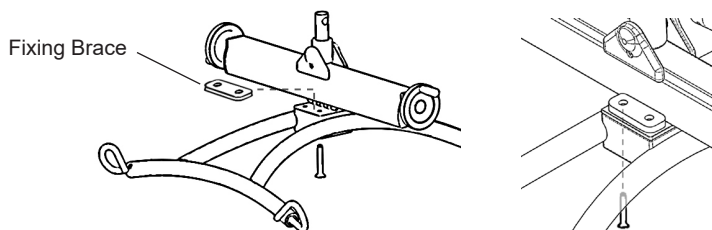

Fig. 7

- Align the fixing brace as shown (See Fig. 8). Insert bolt through attachment cradle and stretcher adjustment and screw into one of the threaded holes on the fixing brace.

**NOTE:** Insert bolt from the underside as shown.



**Fig. 8**

- Insert second bolt through attachment cradle and stretcher adjustment and screw into the remaining threaded hole on the fixing brace (See Fig. 9).

**NOTE:** Tighten to torque of 12Nm.

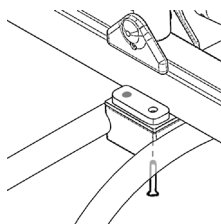

**Fig. 9**

- Repeat steps 3 and 4 for both sides of the assembly.

## Disassembly of Existing Spreader Bar / Cradle:

Disassembly of the existing spreader bar or cradle is quick and easy but it is important that you follow the procedures outlined below carefully.

### **FOLLOW THESE INSTRUCTIONS EXACTLY:**

Before attaching the Stretcher Adjustment Cradle you must remove from the hoist, either the 6-point Spreader Bar or 4-point Cradle, whichever is fitted.

The detachment of the Cradle or Spreader Bar is completed simply by the removal of the quick-release pin. This is done quickly and easily, but you must read the following safety instructions to ensure the Stretcher Adjustment Cradle is safely locked into position before use.

## Removal of existing 4-Point Positioning Cradle / 6-Point Spreader Bar:

### **WARNING**

**Be sure to support the weight of the Spreader Bar / Cradle before removing the quick release pin.**

1. To detach the pin, depress the spring barb using a small flat blade screwdriver or similar device.
2. Pull out the solid pin (which the spring barb is part of) (See Fig. 10, opposite).
3. **Ensure the Spreader Bar / Cradle is fully supported.**
4. Pull out the pin sleeve in the opposite direction, removing it completely from the boom. This will release the Spreader Bar / Cradle completely.

**Ensure the two halves of the black plastic pivot pin covers are retained for reassembly when fitting the Stretcher Adjustment Cradle.**

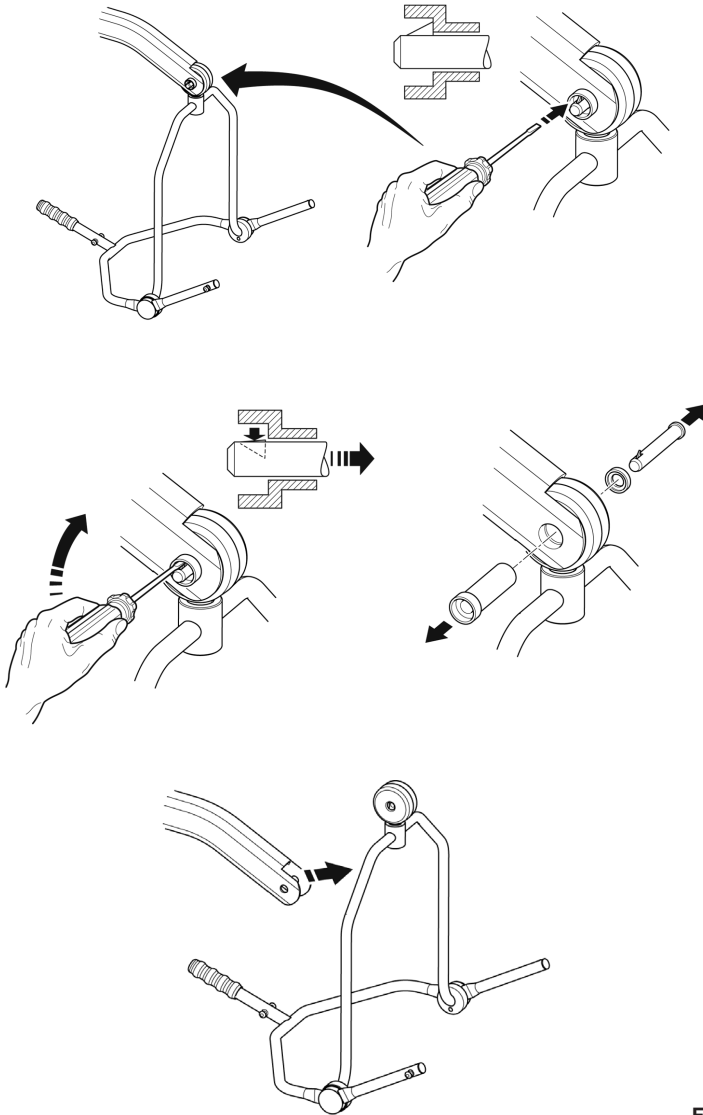

Fig. 10

**Note:** 4-point Positioning Cradle shown for illustrative purposes only.

## Assembly of Stretcher Adjustment Cradle to Lift

Assembly is quick and easy but it is important that you follow the following list of procedures carefully.

### Follow these instructions exactly:

Attachment of the system is completed simply by ensuring the quick-release pin is correctly locked in place. This is conducted quickly and easily, but you must read the following safety instructions to ensure the Stretcher Adjustment Cradle is safely locked into position before use.

### **▲ WARNING**

**When lifting or manoeuvring the Stretcher Adjustment Cradle during the assembly operation, this MUST be performed by two persons, due to the heavy weight of the unit. (15.4kg).**

1. Position the Stretcher Adjustment Cradle on a bed or similar stable supporting surface. Manoeuvre the Stature or Presence hoist into position so that the end of the boom is above the pivot pin on the Stretcher Adjustment Cradle.
2. Lower the boom until positioned immediately above the pivot pin of the Stretcher Adjustment Cradle.
3. Refit the two halves of the black plastic pivot pin covers around the pivot pin, ensuring the central holes align with the horizontal hole in the pivot pin (See Fig. 11 below)
4. Manoeuvre the Stretcher Adjustment Cradle, with the black plastic pivot pin covers in place, so that the hole in the Stretcher Adjustment Cradle pivot pin aligns with the mounting hole in end of the boom.
5. Insert the pin sleeve through the hole in the boom and through black plastic pivot pin covers and the Stretcher Adjustment Cradle pivot pin. Ensure it passes completely through until it protrudes from the other side of the boom (See Fig. 11 below).
6. Insert the quick release pin through the sleeve in the opposite direction until the barb locks into position (See Fig. 11 below).
7. Using the handset, raise the boom slightly until the Stretcher Adjustment Cradle clears the surface it has been supported on. Using both hands, apply a downward pressure to the Stretcher Adjustment Cradle to ensure it is securely attached.

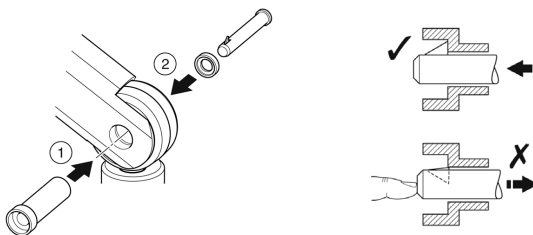

Fig. 11

**⚠ WARNING**

Follow these instructions exactly. Failure to do so could result in injury.

**⚠ WARNING**

Ensure Stretcher Adjustment Cradle is securely attached before attempting to lift.

Your Stretcher Adjustment Cradle is now ready to have the stretcher attached.

**⚠ WARNING**

**OXFORD RECOMMENDS THE USE OF GENUINE OXFORD PARTS.** The Oxford Presence and Canvas Stretcher are designed to be compatible with one another. For country specific guidance on their use and compatibility, please refer to the product label(s) or contact your local market distributor or Oxford.

**⚠ WARNING**

Oxford cannot state that all hoists and stretcher products are compatible. However, should a competent person carry out an appropriate risk assessment prior to prescription, and is confident that the hoist and stretcher can be used together safely, then that decision and responsibility is quite rightly with the prescriber. If in doubt, seek advice.

For instructions on fitting the Canvas Stretcher, please refer to the separate Oxford Canvas Stretcher (SL30010) instruction manual.

**⚠ WARNING**

Ensure the stretcher is securely attached before attempting to lift the patient.

## 4. Lifting With Your Oxford Stretcher Adjustment Cradle

### ⚠ WARNING

When the stretcher is attached to the Stretcher Adjustment Cradle, the patients head and body should always remain horizontal. This balance is achieved by operating the adjustment handles on the Stretcher Adjustment Cradle in either a clockwise or anti-clockwise direction (See Fig.12).

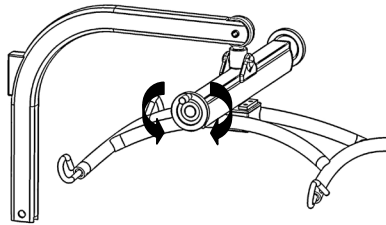

Fig. 12

### ⚠ WARNING

Ensure the patient is positioned in the correct orientation prior to connection of the stretcher to the Stretcher Adjustment Cradle (See Fig. 13).

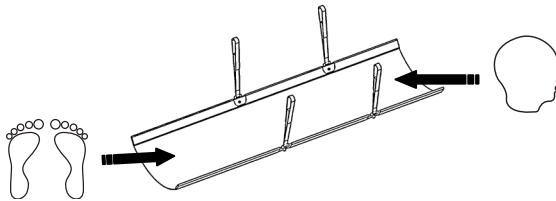

Fig. 13

### ⚠ WARNING

Do not attempt to lift the patient if the patient's weight is off centre balance (See Fig. 14).

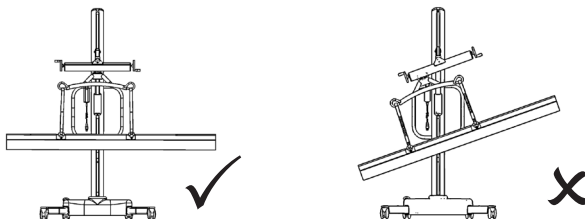

Fig. 14

**⚠ WARNING**

Always plan your lifting operations before commencing the lift.

**Adjusting the balance of the patient using the Oxford Stretcher Adjustment Cradle**

Adjusting the balance of the patient can be achieved by operating either the left hand or right hand adjustment handles on the Stretcher Adjustment Cradle. Rotate the handles either clockwise or anti-clockwise as required to achieve the correct balance (See Fig. 15).

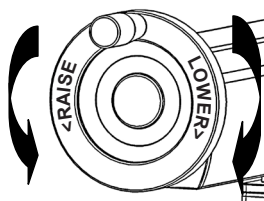

Fig. 15

## 5. Maintenance

### Cleaning

Clean with ordinary soap and water and/or any hard surface disinfectant. Harsh chemical cleaners or abrasives should be avoided as these may damage the surface finish of the product. Avoid wetting any of the electrical parts. After cleaning, the unit should be thoroughly dried.

### End of Life Disposal

**Slings:** Slings and associated material accessories should be sorted as combustible waste in accordance with local or national regulations.

## 6. Warranty

Oxford has an established network of reputable distributors and dealers who will be pleased to handle all your purchasing, warranty, repair and maintenance enquires.

This product is guaranteed for a period of twelve months from the date of manufacture or twelve months from the date of purchase if commissioned by an authorised dealer. We recommend that all of our products are commissioned by your dealer and are supported by them for future servicing.

The dealer or distributor operates the warranty programme, so it is important to keep a record of their name address and telephone number so they can be contacted should any problem arise.

If you are in doubt as to where your product was purchased, Oxford can trace the supplier if you quote the serial number of the lift. Contact details can be found on the rear cover of this manual.

**REMEMBER: Contact your distributor for purchases, warranty, repairs, servicing and certified maintenance.**

**Your distributor:**

---

# oxford

 Oxford Medical Healthcare Ltd  
Drakes Broughton Business Park, Worcester Road, Drakes Broughton  
Persore, Worcestershire, WR10 2AG United Kingdom  
(T) 0344 811 1158 • (W) [www.oxfordhealthcare.co.uk](http://www.oxfordhealthcare.co.uk) • (E) [info@oxfordhealthcare.co.uk](mailto:info@oxfordhealthcare.co.uk)