



200x150  
140x200



TurnSheet is bedded in the bed and features an anti-friction material that makes turning or repositioning higher up in bed easier for both the patient and the caregiver. TurnSheet consists of two sections: a mattress cover and a turning cover. The mattress cover is bedded around the mattress and the turning cover is then placed over it. The mattress cover consists of both anti-friction material and a friction surface. The 140 cm version has two slide panels and the 200 cm has three.

TurnSheet is part of a series of different models of transfer assistive devices. The choice of model and material is determined by the patient's functional capacity and the situations in which the product is to be used.

RoMedic's products together form the SystemRoMedic concept, which takes a holistic approach to patient transfers. SystemRoMedic has four categories of transfers: transfer, positioning, support and lifting.

## Functional inspection

### Visual inspection

Check the condition and function of the product regularly, and always after laundering. Check to ensure that the fabric is not worn, damaged or bleached. If there are signs of wear, the product must be discarded.

## Always read the instructions

Read instructions for all assistive devices used in connection with transfers.  
To prevent discomfort, exercise care and caution when using the product.

## Functional inspection

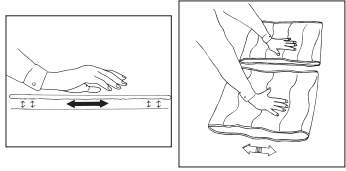

Test Turn Sheet's sliding function by rolling it and noting how easily it glides. If possible, compare with a new product. Similarly, test the friction material in the same way. Check to ensure that the surface is rough and still provides friction.

### Note



Be aware that there is a risk of the patient sliding out of bed. Take care to ensure that the mattress is sufficiently wide, so that there is anti-slip material on both edges of the mattress cover. Do not leave the patient unattended without first raising the bed rails.

### Placement

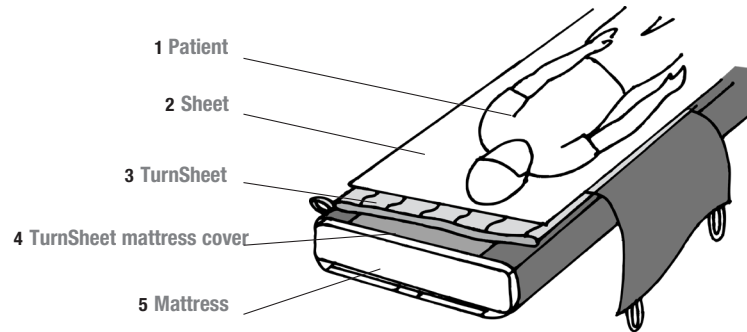

TurnSheet is placed and bedded in the bed in the order described above. The mattress cover is secured around the mattress with Velcro strips. The turning cover is placed on top, with the sliding surfaces facing each other.

## Turning with TurnSheet

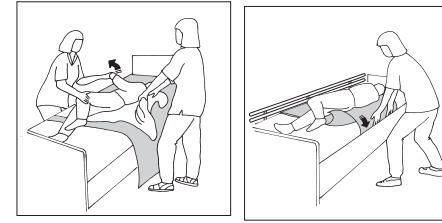

Pull the patient to one side of the bed. Smooth out the sheet and turning cover. Pull on the sheet and turn the patient to the desired position. Tuck the sheet under both sides of the mattress and raise the bed rails.

## Using slide panels

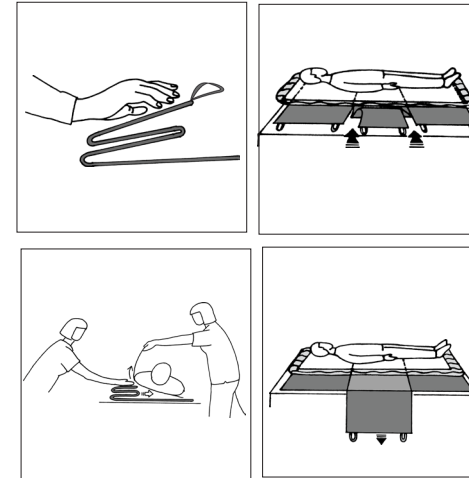

TurnSheet version has two slide panels and TurnSheet 200 has three.

There is friction material under the slide panels. The slide panels can be removed to enable positioning of the patient in bed. For example, the slide panel around the hips can be removed to prevent the patient from sliding downward when he/she attempts to sit up in bed.

Placing and removing the slide panels is easy, since the slide panel is folded against itself and slides in under the patient. Press down and pull forward. This is easier if one caregiver can tilt the patient somewhat.

## Material:

Polyamid, polyester, microfibre

## Care of the product:

Read the product label.



Do not use rinsing agent. To ensure maximum material life, hang dry or tumble dry on low heat.

## Size

1580	140 x 200
1590	200 x 150
1583	Mattress cover to 1580
1593	Mattress cover to 1590

When in doubt, contact your RoMedic representative for product trials, advice or information.

If you require additional information, contact your transfer specialist or our representative, or visit [www.romedic.com](http://www.romedic.com). Make sure you always have the most recent version of the manual. Manuals are available for downloading from our website; <http://www.romedic.com>

RoMedic AB

Box 640

SE-175 27 Järfälla

SWEDEN

Tel: +46 (0)8-594 773 33

Fax: +46 (0)8-594 773 44

Internet: [www.romedic.com](http://www.romedic.com)

E-mail: [office@romedic.com](mailto:office@romedic.com)

**RoMedic**<sup>®</sup>  
A company in the Handicare Group