

We reserve the right to upgrade the software and product and/or to make changes to this user manual without prior notice. The icons in this user manual may slightly differ from your phone, depending on the phone you purchased. All rights reserved.

Safety Instructions

This user manual includes important safety information. Please read below instructions carefully. It may be dangerous or illegal if you do not follow these instructions.

Pay attention to Traffic Safety

Obey local traffic laws and do not use the phone while driving. Using a cell phone while driving is dangerous and it is illegal in some areas. Radio frequency (RF) signals may affect improperly installed or inadequately shielded electronic systems in motor vehicles such as electronic fuel injection systems, electronic antiskid (antilock) braking systems, electronic speed control systems, and air bag systems. For more information, check with the manufacturer of your vehicle for any equipment that has been added. Do not place objects, including installed or portable wireless equipment in the area over the air bag or in the air bag deployment area.

Pacemaker Interference

Pacemaker manufacturers recommend that a minimum separation of 15.3 centimeters (6 inches) be maintained between a wireless phone and a pacemaker in order to avoid potential interference with the pacemaker.

Turn Off Your Cell Phone in Medical and Health Care Facilities.

Switch off your device in health care facilities when any regulations posted in these areas instruct you to do so. Hospitals or health care facilities may be using equipment that could be sensitive to external RF energy.

Switch Off on Airplanes

Using your device while flying in aircraft is prohibited. Switch off your device before boarding

an aircraft. The use of wireless devices in an aircraft may be dangerous to the operation of the aircraft, disrupt the wireless telephone network, and may be illegal.

Accessories and Batteries

Use only the approved accessories and batteries. Please do not try to use with any product that was not manufactured for use with this phone. Please be sure the phone has been switched off before taking out the battery. Please dispose of scrap batteries properly according to the local regulations.

Cell Phone Should Be Turned Off Near Sites of Explosion.

Potentially explosive atmospheres include areas where you would normally be advised to turn off your vehicle engine. Sparks in such areas could cause an explosion or fire resulting in bodily injury or even death. Switch off the device at refueling points such as near gas pumps at service stations and in any area with a potentially explosive atmosphere and obey all signs and instructions. Observe restrictions on the use of radio equipment in fuel depots, storage, chemical plants or where blasting operations are in progress.

Using the Phone Correctly

Please use this phone in its normal intended position. Do not let children use the phone without supervision. Your phone contains small parts such as SIM card, which can be accidentally swallowed by a child.

Your Phone is Not Waterproof

This phone is not waterproof. Please do not expose your phone to wet weather or environment (such as rain, snow, seawater, etc.).

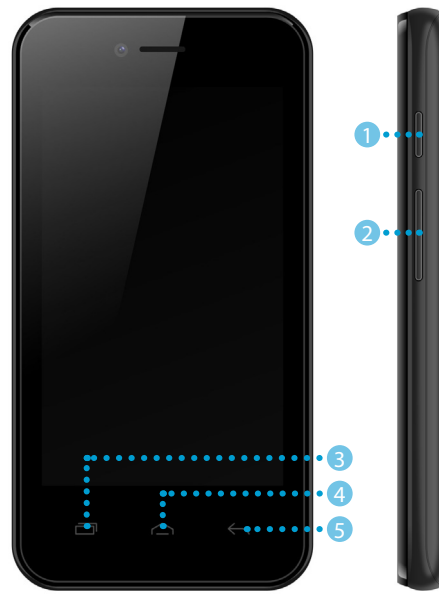

Your Phone

- Power key**
Press and hold to switch on and off the phone
- Volume Keys**
Press to increase and decrease the volume
- Menu Key**
Opens the related menu with additional options and actions, depending on the application. Press and hold to open a list of recent applications.
- Home button**
Returns to the Home Screen
- Back key**
Returns to the previous screen you were working on

Network Signal Status	Alarm	Data is syncing
WiFi Network	Aeroplane mode	Problem with sign in or sync
Battery Status	Silent mode	Downloading data
Battery is charging	Handset mode	Microphone muted
Bluetooth	New Email Message	Vibrate mode
Missed Call	Headphones are connected	Mobile data is on
New Text Message	Upcoming event	Hotspot is on

Getting started

Remove the Back Cover

Open the battery cover carefully by prising open from the bottom left corner where you will find a small notch. Install the SIM card and battery.

For availability and information about using SIM card services, contact your SIM card vendor. This may be the service provider, network operator, or other vendor.

Note: The SIM card and its contacts are easily damaged by scratches or bending, so please be careful when handling, inserting, or removing the card.

Note: Keep all SIM cards out of the reach of small children.

- Ensure the phone is switched off and the charger is disconnected before removing the battery.
- With the back cover removed, install the SIM card by sliding it into the nest. For SIM slot 1 ensure the angled corner is on the top left hand side and lower left hand side for SIM slot 2. The phone is a dual sim and can accept two sim cards that can work at the same time or you can use one sim. Both sim slots will only accept micro size sim cards. You can also install a micro SD memory card into the slot above the SIM slot 2.
- Install the battery into the battery slot, ensuring that the three metallic stripes on the battery align with the three metallic prongs in the battery slot.
- Put on the battery cover. Ensure the cover is completely closed and the matching sound (click) could be heard.
- Plug the phone in to charge it fully.

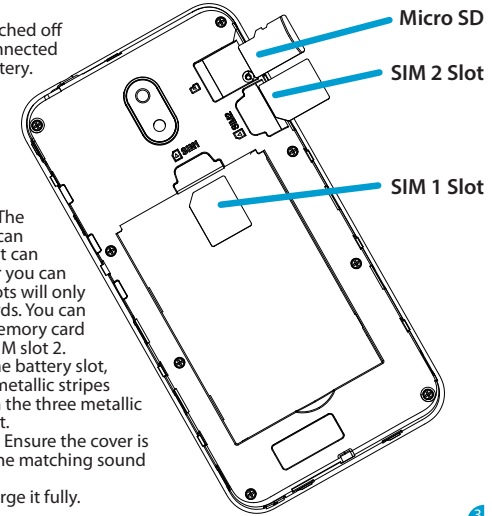
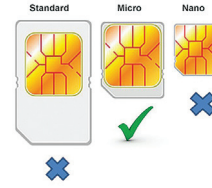

Power On your Phone

Press and hold the power button on the right hand side of the phone for about 3-5 seconds. The phone will boot up and start the wizard prompting you to choose language, enter the wifi details and your Google account login, please note Wi-Fi or data connection will be required. Even if no SIM card is installed, your phone will still power on and you will be able to connect to a Wi-Fi network and use some of the phone's features.

Set up your phone for the first time

The first time you power on the phone, you should set the following options:

- Select the phone's language, then press Start to go next.
- Select an enabled Wi-Fi, then press Start to go next.

Power off your phone

To turn your phone off, hold down the Power Key and select Power off.

Unlock the device

To unlock the device you may need the PIN, password, or pattern drawing.

- Press the power key to wake up the phone.
- Hold and drag the unlock icon upward to unlock.

The process of unlocking depends what was set. To set the unlock method:

- On the main menu, go to Settings/Security.
- Touch Set up screen lock.
- Choose the type of locking as desired. You can set your screen lock on the basis of Swipe, Pattern, PIN, Password or None.

Charging the Battery

The battery can be charged when the phone is either on or off. Please ensure the battery is inserted into the phone before charging. The

charging time is three hours.

To connect the charger:

- Insert the cord into its port on the top panel of the phone
- Plug the other end of the cable into either a computer USB socket or use any USB mains charger that runs at 240V.

To disconnect the charger:

- Unplug the wall charger.
- Remove the cord from the phone.

PLEASE NOTE: The Ttfone TT20 does not come with a charger, you can use any USB mains plug or plug the cable into your PC or Laptop to charge the phone. If you do not have one of these you can purchase a charger from www.ttfone.com

Using the Touch screen

You can use the touch screen in the following ways:

- Touch:** Acts on items on the screen, such as application and settings icons, to type letters and symbols using the onscreen keyboard, or to press onscreen buttons.
- Touch and hold:** Touch and hold an item on the screen until an action occurs.
- Drag:** Touch and hold an item and move your finger on the screen until you reach the target position.
- Swipe or slide:** Quickly slide your finger across the surface of the screen, (without dragging an item). For example, slide the screen up or down to scroll a list.
- Double tap:** Tap quickly twice on a webpage, map, or other screen to zoom. For example, double tap a section of a webpage in Browser to zoom that section to fit the width of the screen. You can also double tap to zoom, in Maps, and in other applications.

- Pinch:** In some applications (Such as Maps, Browser, and Gallery) you can zoom in and out by placing two fingers on the screen at once and pinching them together (to zoom out) or spreading them apart (to zoom in).
- Rotate the screen:** On most screens, the orientation of the screen changes as you rotate it. You can turn this feature on and off.

Status bar and Notices

The Status Bar appears at the top of the screen. This displays notification icons, such as the current time, missed calls or received messages (on the left) and phone status icons, such as battery status (on the right). The Notices Panel will display notifications when you miss calls, receive new messages or have upcoming events. From the home screen pull down from the top of the phone to view and select these notifications.

Wi-Fi

Switch on Wi-Fi by going to Settings/Network & Internet/WiFi select the available network and enter the password (if needed) press CONNECT when done. The TT20 can be used as a WiFi hotspot by navigating to Settings/Network & Internet/Hotspot & tethering (will only work if you have mobile data).

Google Play

Google Play is your entertainment unbound. It brings together all of the entertainment you love and helps you explore it in new ways, anytime, anywhere.

Battery Level Indication



Low Battery Alert

The phone will sound an alert when the battery is low and display a message of low battery on the screen.

Making/Receiving Phone Calls

To Make Calls

Open the phone app, press the number pad button on the lower right of the screen, enter the number and press the call key to call.

- To delete a digit, press the delete key.
- To clear the screen, press the back key once. You can also make calls directly from the contact list by going to Menu/Contacts select your contact, select phone number and press the CALL button.

Call Log

Access the call log to see your last dialed, missed and incoming calls go to the Phone App/Call History, use the touchscreen to navigate and select a number, press the Call button next to it to call that number.

To Answer Calls

When your phone rings, swipe up to answer the call or press the answer key.

To End a Call

To end a call, press the end key.

To Reject a Call

To reject the call without answering, swipe down when your phone rings or press the decline key.

To Redial a Number

- Go to Phone App/Call History, this will show your call history.
- Select the number you want to dial then press the Call key to call.

Making International Calls

- Hold down the 0 key until a "+" character appears on the screen.
- Enter the country code, area code and phone number as instructed by your long distance network service carrier.
- Press the Call key to call.

Changing the Volume during a Call

To change the volume during a call press the up or down volume key. To change the volume of your media apps, ringtones, alerts and alarms, go to Menu/Settings/Sound.

Ringtone volume

You can adjust the ringtone volume in Settings/Sound/Ring volume. From here you adjust the volumes for the ff: Media, Call, Ring, & Alarm.

Silent Mode

Simply go to Settings/Sound and change Ring Volume to Silent or on the home screen press the volume down key repeatedly on the side of the phone until silent mode appears.

Vibration

Simply go to Settings/Sound and change Ring to Vibrate.

Aeroplane Mode

Some locations may require you to switch off data connections. Instead of turning off your device, you can set it to Aeroplane Mode. From the Home Screen pull down the notification panel to display the shortcuts menu and select the aeroplane icon. Flight mode will disconnect all your network data, Wi-Fi and connectivity connections. You can also access through Settings/Network & Internet/Airplane mode.

Data Roaming

With a mobile data plan from your network operator you will be able to access internet feature apps when not in a Wi-Fi zone. Contact your operator for more information of data plans.

Transferring Media

Transfer your favorite music and pictures between your TT20 and PC. Connect your device to a PC with the USB power cable and go to Settings/Connected devices/USB/Media Device or from your home screen pull down the notification panel and select Android™ System. Your device will be displayed as a removable device, showing the phone's internal storage. If a memory card is inserted, the microSD card details will also be visible. Copy the chosen files to the device.

Messages (SMS)

Writing and Sending a Message

Go to Messages/Start Chat. In the "To" field, you can select a contact from your contact list or press the number pad to enter numbers manually. Write the message using the on screen keyboard, press the delete key to delete the last character. Press the plus button to attach an image or share a contact. Press the Send button.

Contacts

Store all your contact information in the phone book and easily access all your friends and family. Go to Menu/Contacts.

- Press the + button on the lower right of your screen and choose to save your contact on the phone or the sim card

2. Enter the name and phone number of the contact
3. Press SAVE

Transfer Contacts from your old phone

To add contacts from your Gmail or outlook account or your memory card go to **Contacts/Options/Settings/Import Contacts**.

Speed dial settings

Set favourite numbers from your Phone App/Speed dial or go to **Contacts**, select a saved contact and press the star button to set as a speed dial, only contacts that are saved to phone memory can be set as a speed dial. Press the image of the contact to call the saved phone number.

APPS

Please note some of the following apps need an internet connection to use their services. It is recommended to use Wi-Fi connections when available to reduce costs for data traffic. Contact your service provider for detailed subscription costs. To access the APPS from the home screen swipe up from the home screen to display the app tray, use the navigation key to select your chosen app.

Internet/Chrome browser

The TT20 comes with a simplified Internet browser you can use to access your favourite websites. Go to **Menu/Browser** select **SEARCH**, enter the web address and select **GO**.

Google Go

It is a lightweight search app that takes less space and memory. This app is very helpful that it works even on slow data/internet connection.

ringtone SIM 2. From here you can set your preferred ringtone for each SIM.

Storage

The TT20 has 8GB internal memory. For extra memory space you can install a micro SD card (which is sold separately) no larger than 128GB.

Accessibility Options

Navigate to **Menu/Settings/Accessibility** to find helpful features like talkback, font size, display size, mono audio, audio-balance and colour invert.

Restore Settings

Go to **Settings/System/Reset Options/ Erase all data** to restore the phone back to factory settings. If you restore the factory data, your device will reset to the settings that were configured at the factory. All of your personal data from the internal device storage, including account information, the system and application settings, and any downloaded applications will be erased. Resetting your device does not erase any system software updates that have been downloaded or any files on a microSD card, such as music or photos.

Troubleshooting

Before contacting the service Centre, you are advised to follow the instructions below:

You are advised to fully charge the battery for optimal operation. Avoid storing large amounts of data in your phone as this may affect its performance. Use the **Wireless Update** tool to update your phone's software. To access Update phone, press **Settings/About phone/System update**.

Google Duo

Google Duo is a simple and reliable video calling app from Google. You will need WiFi or Data, a phone number and a Google account to set up and use.

Google Assistant Go

Google Assistant is Google's voice controlled smart assistant that allows you to search for information online, open apps on your phone, send messages, etc. To access Google Assistant open the Google Assistant app or just say "hey Google". Speak into the microphone of the device clearly and follow the on screen instructions.

YouTube

YouTube is an online video-sharing application where users can upload, view, and share videos. Available content includes video clips, TV clips, music videos, and other content such as video blogging, short original videos, and educational videos. It supports a streaming function that allows you to start watching videos almost as soon as they begin downloading from the internet.

Youtube Music

You can stream and browse playlists, albums and artists from Youtube platform. You can also play your music files from your device. Music files can be transferred from a PC onto your TT20 so you can listen to music wherever you are. Ensure that the USB storage has been enabled **Settings/Connected device/USB/Media**, after you connect the phone to a PC using the USB cable. On the PC navigate to the USB drive and copy your music across.

Google Maps Go

Google Maps offers satellite imagery, road condition, topographic map and route

My phone can't be switched on or is frozen

1. Check the battery contacts, remove and reinstall your battery, then turn your phone on.
2. Check the battery power level, charge for at least 20 minutes.

My phone has not responded for several minutes

1. Restart your phone by pressing and holding the Power key
2. Remove the battery and re-insert it, then restart the phone.

My phone turns off by itself

1. Check whether your phone screen is locked when not in use, and make sure you don't accidentally turn off your phone when locking it by pressing the Power key
2. Check the battery charge level.
3. Make sure that Scheduled power on/off is disabled, go to **Settings/Scheduled power on/off**.

My phone can't charge properly

1. Make sure you are using a TTFone battery and the charger cable from the box.
2. Make sure your battery is inserted properly and clean the battery contact if it's dirty. It must be inserted before plugging in the charger.
3. Make sure that your battery is not completely discharged; if battery power is empty for a long time, it may take around 20 minutes to display the battery charger indicator on the screen.
4. Make sure charging is carried out under normal conditions (0°C to +40°C).
5. When abroad, check that the voltage input is compatible.

planning for traveling by foot, car, or public transportation. By using this application, you can get your own location, search for a place, and get suggested route planning for your trips.

Gmail

You can use the TT20 to read and send email messages. Add an email account by going to **Menu/Gmail** and follow the instructions. Write an email by going to **Menu/Email** and select **COMPOSE**, in the "To" field type the email address, add your subject and email content and press **SEND**. You can also add attachments, reply and forward emails and even search for emails using the options menu.

Camera

Your mobile phone is fitted with a camera for taking photos and shooting videos:

- Store them to your "Files".
- Send them in a message to a mobile phone.
- Customise your Home screen.
- Transfer them by data cable or memory card to your computer.

To take a picture navigate to **Menu/Camera** and press the capture key to capture the image.

The TT20 is also fitted with a front camera for taking selfies and using for video calls. To change the camera to the front press the rotate Camera button at the top right of your screen. Take pictures with a timer swipe the screen to the left and select Countdown duration in the camera app.

To view the photos you have taken go to **Menu/Gallery**.

Video

Take videos by going to **Menu/Camera** and then press the video button. Use the video button to start and stop recording. To view the video recordings go to **Menu/Gallery**.

My phone can't connect to a network or "No service" is displayed

1. Try connecting in another location.
2. Verify the network coverage with your operator.
3. Check with your operator that your SIM card is valid.
4. Try selecting the available network(s) manually.
5. Try connecting at a later time if the network is overloaded.

My phone can't connect to the Internet

1. Make sure that the internet access service of your SIM card is available.
2. Check your phone's Internet connection settings.
3. Make sure you are in a place with network coverage.
4. Try connecting at a later time or another location.

Invalid SIM card

1. Make sure the SIM card has been correctly inserted.
2. Make sure the chip on your SIM card is not damaged or scratched.
3. Make sure the service of your SIM card is available.

Unable to make outgoing calls

1. Make sure you have dialled a valid number and have pressed the call button.
2. For international calls, check the country and area codes.
3. Make sure your phone is connected to a network, and the network is not overloaded or unavailable.
4. Check your subscription status with your operator (credit, SIM card valid, etc.).
5. Make sure you have not barred outgoing calls.

Sound Recorder

Use the sound recorder to record voice notes and messages by going to **Menu/Sound Recorder**.

FM radio

Play your favourite FM radio stations, using a wired headphone will give better reception. Go to **Menu/FM Radio** and press the **On/Off** button on the screen and press the arrow buttons to scan for available stations.

NOTE: The quality of radio sound depends on signal quality at your location. The headphones act as an aerial so you will get better reception when they are plugged in.

Gallery

This is where you can view and manage your saved pictures and video by going to **Menu/Gallery**.

Clock

You can add more than 10 Alarms and you can also access timer and stopwatch. Go to **Menu/Clock**.

Calendar

Use Calendar to create and manage events, meetings and appointments. Depending on your synchronisation settings, the calendar on the device remains synchronised with the calendar on the web.

Open the calendar by going to **Menu/Calendar** and press the plus button on the lower right of the screen to start adding a new event. Set the time and date and event details then press **SAVE**.

Calculator

The Calculator can perform basic mathematical operations. Go to **Menu/Calculator** to open the app.

6. Make sure that your phone is not in aeroplane mode.

Unable to receive incoming calls

1. Make sure your phone is switched on and connected to a network (check for overloaded or unavailable network).
2. Check your subscription status with your operator (credit, SIM card valid, etc.).
3. Make sure you have not forwarded incoming calls.
4. Make sure that you have not barred certain calls.
5. Make sure that your phone is not in Aeroplane mode.

I can't find my contacts

1. Make sure your SIM card is inserted properly.
2. Import all contacts stored in SIM card to phone.

The sound quality of the calls is poor

1. You can adjust the volume during a call by pressing the Volume Up/down key.
2. Check the network strength
3. Make sure that the receiver, connector or speaker on your phone is clean.

When I select a number from my contacts, the number can't be dialled

1. Make sure that you have correctly recorded the number in your file.
2. Make sure that you have selected the country prefix when calling a foreign country.

I am unable to add a contact in my contacts

Make sure that your SIM card contacts are not full; delete some files or save the files in the phone contacts.

I can't access my voicemail

1. Make sure your operator's voicemail number is correctly entered.

Files

Manage the contents and properties of files. You can open, delete, move, copy and rename files.

Settings

Setting the date and Time

When you first turn on your device, there is an option to update the date and time automatically using the time provided by your network. You can't set the date, time, and time zone manually if using the automatic option. To manually adjust the date and time settings go to **Menu/Settings/System/Date & Time**.

Lock Screen

Your lockscreen shows date and time and your notifications, double tap the notification to open it. Customise your lockscreen notification by going to **Settings/Apps&Notifications/Notifications/Lockscreen**. To unlock your screen, press the power key and swipe up.

Display Settings

Go to **Menu/Settings/Display/Brightness** to adjust the screen brightness levels.

Change Wallpaper

Change Wallpaper of the home screen by going to **Settings/Display/Wallpaper**.

Screen Timeout

If your device is idle for a period of time, the screen will turn off to save battery power. To set a longer or shorter time go to **Menu/Settings/Display/Screen Timeout**.

Using the keyboard

You can change your keyboard settings i.e sound, vibration simply go to **Settings/**

2. Try later if the network is busy.

SIM card PIN locked

Contact your network operator to obtain the PUK code (Personal Unblocking Key).

The phone can't be detected by others via Bluetooth

1. Make sure that Bluetooth is turned on and your phone is visible to other users.
2. Make sure that the two phones are within Bluetooth's detection range.

Radio Frequency (RF) Exposure and SAR

This device meets international guidelines for exposure to radio waves. Your mobile device is a radio transmitter and receiver. It is designed and manufactured not to exceed the limits for exposure to radio frequency (RF) radiation recommended by international guidelines (ICNIRP). These limits are part of the comprehensive guidelines and establish the permitted levels of RF energy for the general population. The guidelines were developed by independent scientific organizations through periodic and thorough evaluation of scientific studies. The exposure standard for mobile devices employs a unit of measurement known as the Specific Absorption Rate, or SAR. Although the SAR is determined at the highest certified power level, the actual SAR of the device while operating can be well below the maximum value. This is because the device is designed to operate at multiple power levels so as to use only the power required to reach the network. In general, the closer you are to a base station, the lower the power output of the device. SAR values may vary

Settings/Sound/Advanced/Other Sounds & Vibration.

Android updates

To check your version number or to get the latest system update for your TT20. Go to **Settings/About Phone** then look for system updates.

Wireless Update

Using the **Wireless Upgrade** tool you can update your phone's software. To access Update phone select **Settings/About phone/Wireless Update**. If you want to update the system, select **Download**, after it is done please select **Install** to complete the upgrade. Now your phone's software will be the latest version. You should turn on data connection before searching for updates. Settings for auto-check intervals is also available once you restart the phone. If you have chosen auto-check, when the system discovers the new version, the notification also will show in status bar.

Bluetooth®

Use **Bluetooth®** on the TT20 to connect to your headset, car or to transfer files from one phone to another. Navigate to **Settings/Connected devices/Connection preferences/Bluetooth®**. Switch on **Bluetooth®** and pair your devices, make sure the other device is set to discoverable mode.

Security

Set a screen lock of your choice either None, Swipe, pattern, PIN or Password. Go to **Settings/Screen lock** and follow on screen instructions.

Change Ringtones

Change ringtones by going to **Settings/Sound/Phone ringtone SIM 1 and Phone**

depending on national reporting and testing requirements and the network band. Use of device accessories and enhancements may result in different SAR values. The SAR limit for mobile devices used by the public is 2.0 w/kg (watts per kilogram) averaged over 10 grams of body tissue. The guidelines incorporate a substantial margin of safety to give additional protection for the public and to account for any variations in measurements. The highest SAR Value - 0.85 w/kg.

Some features of the product and its accessories described herein rely on the software installed, capacities and settings of local network, and may not be activated or may be limited by local network operators or network service providers. Therefore, the descriptions in this manual may not exactly match the purchased product or its accessories.

The manufacturer reserves the right to change or modify any information or specifications contained in this manual without prior notice or obligation.

The manufacturer is not responsible for the legitimacy and quality of any products that you upload or download through this device including text, pictures, music, movies, and non-built-in software with copyright protection. Any consequences arising from the installation or usage of the preceding products on this device is accountable to you.

Check out our other fantastic range of products at www.ttfone.com

Google, Android, Google Play, YouTube and other marks are trademarks of Google LLC.

TTFone www.ttfone.com